

## MyChart COVID Vaccine Information Access

### Quickly Access Your Vaccine and Testing Details

From the MyChart App login screen set up option to view.

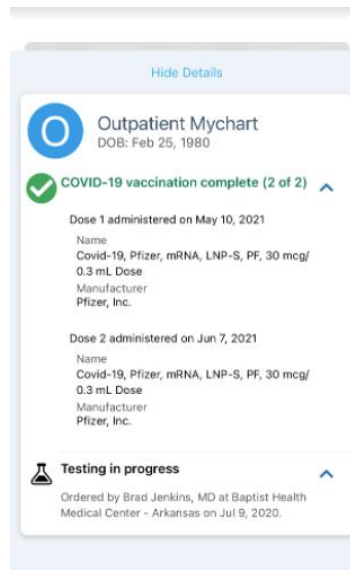
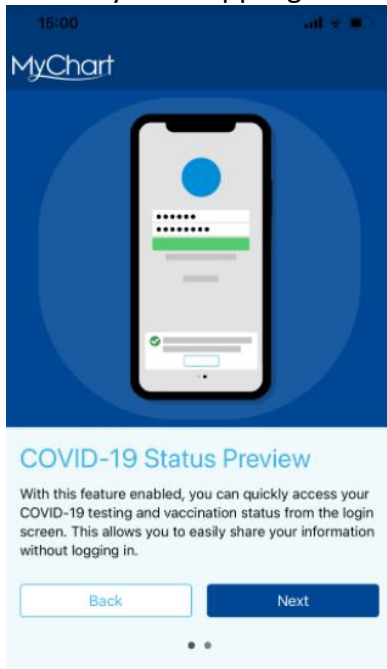

## Query or Enter Your Vaccine

Update to query your vaccine record from the state registries.

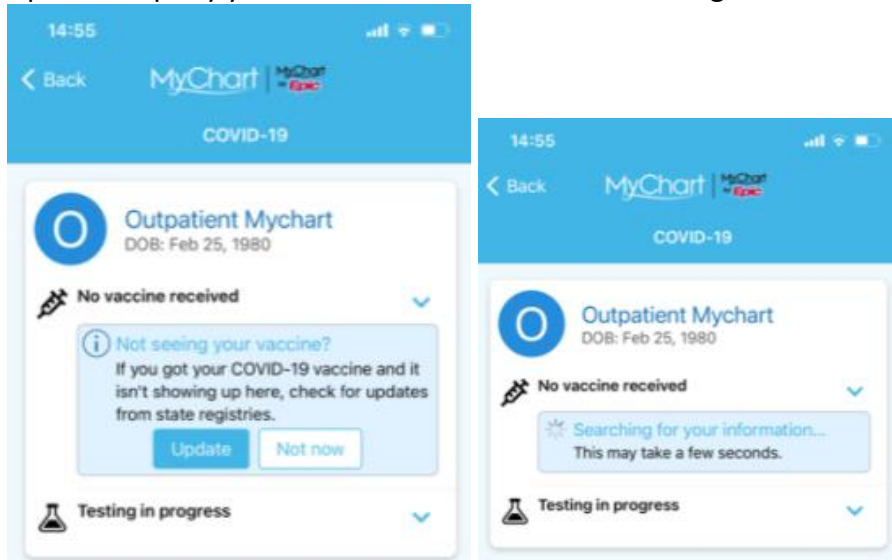

If nothing is returned from query, manually enter your vaccine information to be reconciled to the chart. Add an image of your vaccine card to be part of your record.

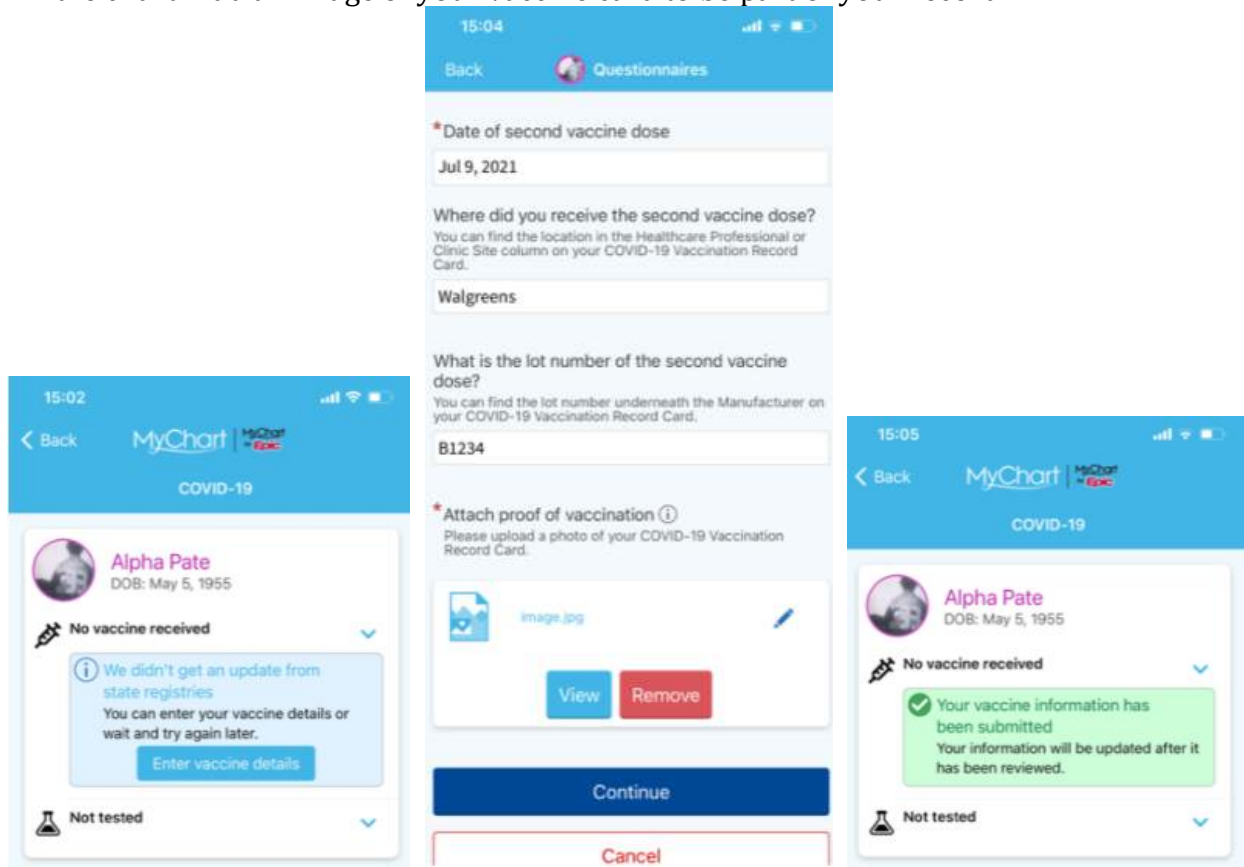

## Share Your Vaccine with QR or PDF

Access your vaccine information to share as needed for scanning or as paper proof of vaccination.

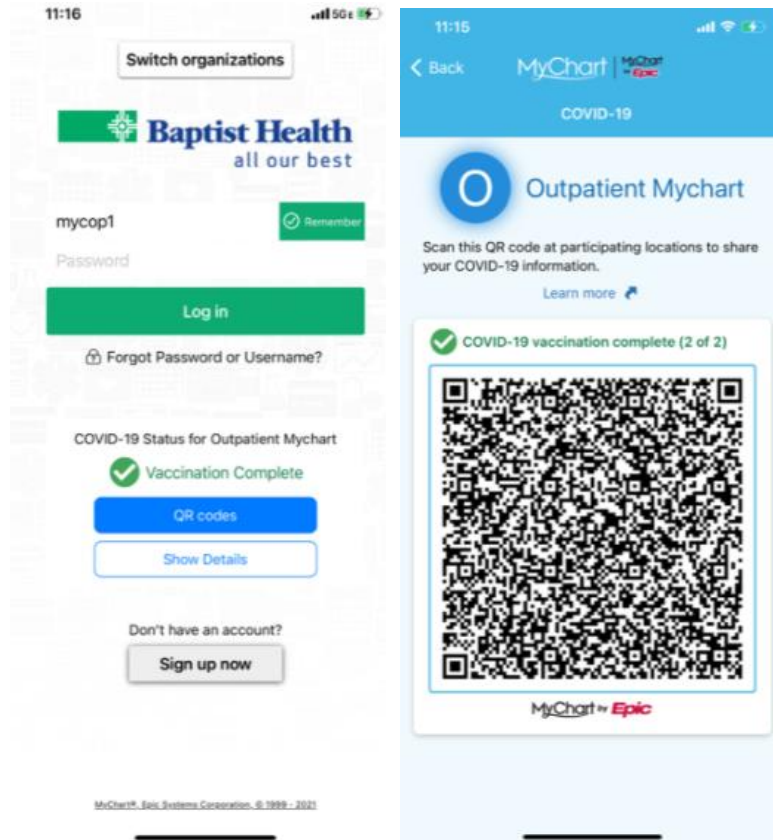

From within MyChart, access in the COVID-19 activity.

